



## SMILE Instrument Set



The ReLEx™ SMILE is a refractive correction procedure from Carl Zeiss Meditec AG, which is carried out in a single step with a femtosecond laser, without the need to cut a flap.

The femtosecond laser creates a refractive lenticule (a thin round section of corneal tissue formed by creating a lower then upper femtosecond laser pass) in the centre of the cornea. A small incision, less than 4mm, is then made in an otherwise intact cornea.

The lenticule is then released from the cornea by using a fine spatula (6-835, 6-836 or 6-836-1) and then removed through the small incision using a fine pair of forceps (2-836).

The removal of the lenticule has now permanently reshaped the cornea to correct the refractive error.

### 6-835 SMILE Double Ended Dissector

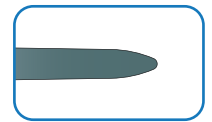
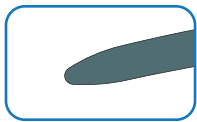

- 0.4 diameter bullet shaped tip
- 60° angled curved shaft, tip to angle length 9.5mm
- Laser markings on angled shaft at 7mm, 7.5mm and 8mm

- 0.25 diameter bullet shaped tip
- 60° angled shaft, tip to angle length 2mm
- Round handle, length 117mm

### 6-836 SMILE Double Ended Dissector with spoon tip

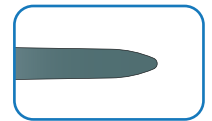
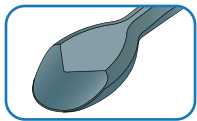

- 1.25 x 0.35mm spoon shaped tip
- 70° angled curved shaft, tip to angle length 9.5mm
- Laser markings on angled shaft at 7mm, 7.5mm and 8mm

- 0.25 diameter bullet shaped tip
- 60° angled shaft, tip to angle length 2mm
- Round handle, length 116mm

### 6-836-1 SMILE Double Ended Dissector with Taneri spoon tip

Semi-sharp spoon shaped-tip facilitates lenticule dissection in every direction, including reverse movements

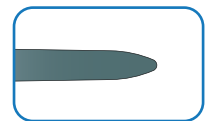
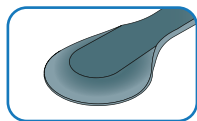

- 1.25 x 0.3mm semi-sharp spoon shaped tip
- 60° angled straight shaft, tip to angle length 8.5mm
- Laser markings on angled shaft at 7mm, 7.5mm and 8mm

- 0.25 diameter bullet shaped tip
- 60° angled shaft, tip to angle length 2mm
- Round handle, length 116mm

### 6-837 SMILE Lenticule Hook



- 1mm wide 3 pronged hook tip up & tip down
- 70° angled shaft, tip to angle length 10mm
- Round handle, length 123mm

### 2-114 *Castroviejo Suturing Forceps (0.12mm)*

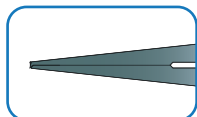

- 0.12mm, 1 x 2 teeth, 6mm tying platforms
- Straight shafts
- Standard long handle, length 116mm

### 2-836 *SMILE Lenticule Removal Forceps*

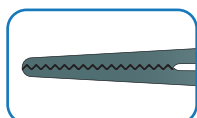

- 4mm long serrated jaws
- 30° angled shafts
- Flat long handle, length 119mm

### 2-837 *SMILE Lenticule Removal Forceps, 23 Gauge*

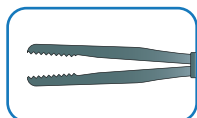

- Delicate serrated jaws with blunt tip, tip length 3mm
- Curved 23 gauge tube
- Squeeze handle activates both jaws
- Round squeeze handle, length 127mm

### DK7003 *Sterilising Tray*

- External dimensions: 173mm x 110mm x 25mm
- Suitable for 6 instruments
- One silicone mat

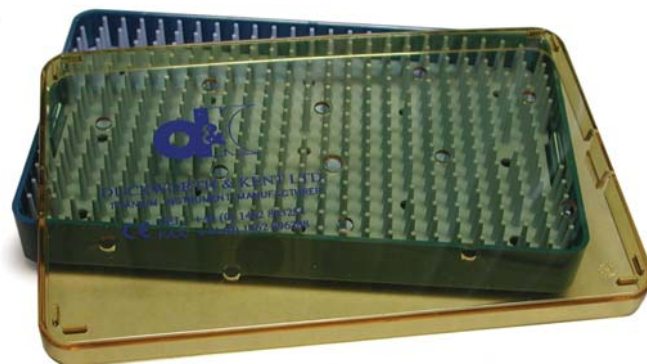

9100 Watson Road  
Suite 100  
St. Louis, MO 63126-2241 USA  
www.crestpointmgt.com  
Tel: (314) 849-7773  
Fax: (314) 849-7776  
Email: custsvc@crestpointmgt.com  
ZDC XXX  
Exclusive Distributor in the USA and Canada

© May 2015 Duckworth & Kent  
Revised 12.01.2017

Email: [info@duckworth-and-kent.co.uk](mailto:info@duckworth-and-kent.co.uk)

Tel: +44 (0)1462 893254

Fax: +44 (0)1462 896288



[www.duckworth-and-kent.com](http://www.duckworth-and-kent.com)